



**TRAQ**  
Quality with  
a system

PEOPLE LIGHT OUR WAY

# TRAQ

## Quality with a system

**TRAQ** is our first-class continuous-row lighting system that impresses across the board with its high efficiency, flexibility and durability. The future-oriented optics specially developed for **TRAQ** ensure uniform, glare-free light with outstanding colour rendering. With five different beam angles and a variety of extension modules **TRAQ** offers endless customisation options for different requirements and environments. Whether in industry or in the office – this system is ready to master the challenges of the future.

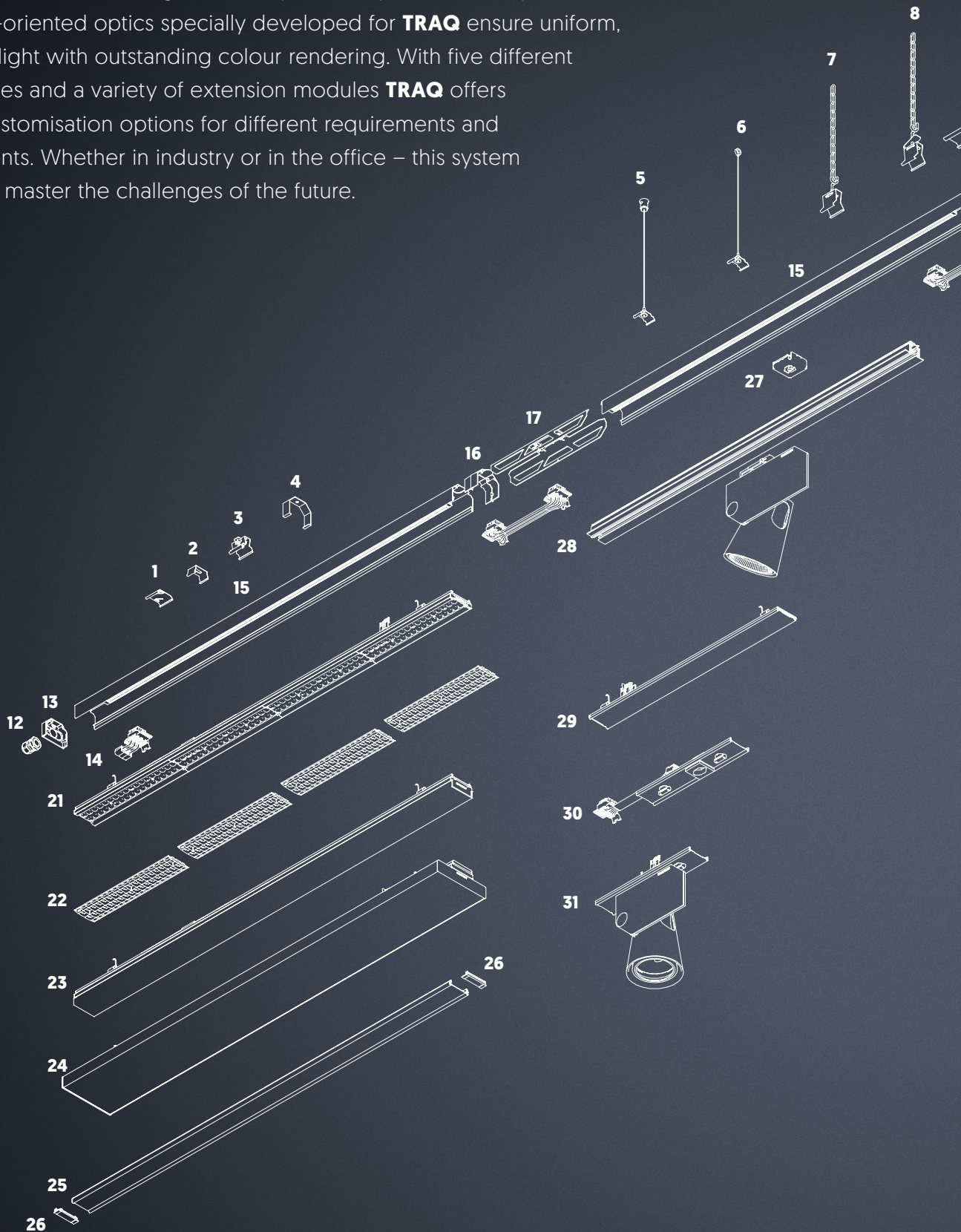



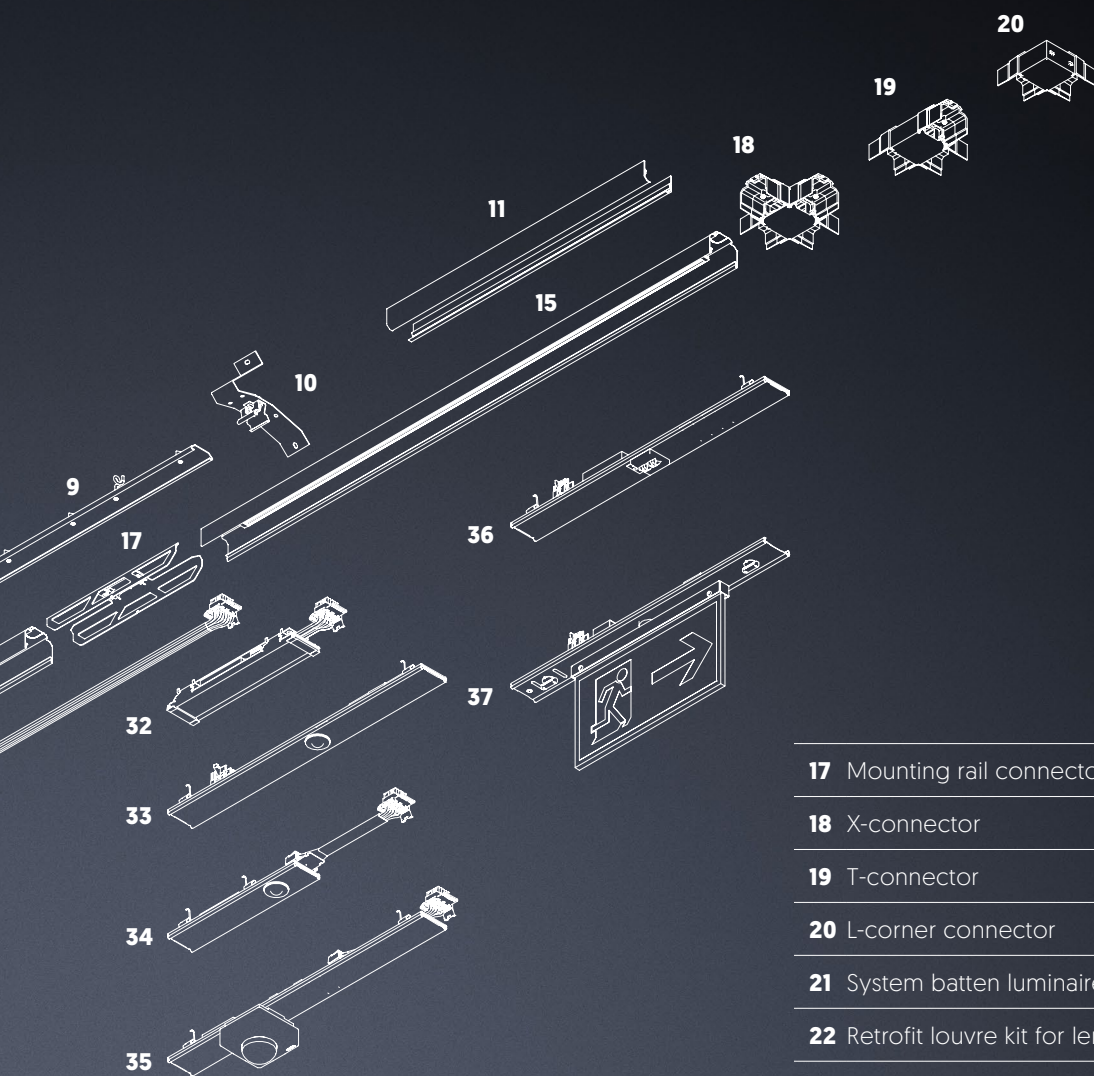

**1** Loop for system ceilings

**2** Ceiling mount, flat

**3** Ceiling mount, for use with safety screw

**4** Safety clamp for blind cover or lens modules (IK07)

**5** Wire cord suspension with ceiling mount

**6** Wire cord suspension with loop

**7** Plain coil chain and element, with setting nut

**8** Plain coil chain and element, with quick adjustment

**9** Mounting rail connector for sloped mounting or stabilization

**10** Bracket for mounting on sloped ceilings (30°, 45°, 60°)

**11** Cable channel

**12** Cable gland for front cable entry\*

**13** End cap

**14** Mains infeed

**15** Mounting rail with/without power supply

**16** IP54 gasket for mounting rail\*

**17** Mounting rail connectors mechanical and electrical

**18** X-connector

**19** T-connector

**20** L-corner connector

**21** System batten luminaire TRAQ (with lens module)\*

**22** Retrofit louvre kit for lens modules

**23** System batten luminaire TRAQ Case (with diffuser)\*

**24** System batten luminaire TRAQ Office (with diffuser)

**25** Blind cover

**26** IP54 gasket for blind cover\*

**27** Retainer for mechanical mounting of other luminaires

**28** TRAQ Equip track  
(with Global track for connecting spotlights)

**29** Empty section of profile for mounting further elements

**30** Socket strip

**31** Matrix mounting rail spotlight for direct mounting

**32** Strip with PIR-based motion detector (up to 4 m)\*

**33** Strip with PIR-based motion detector (up to 4 m)

**34** Strip with PIR-based motion detector and daylight control (up to 5 m\* or 10 m)

**35** Strip with PIR-based motion detector (up to 14 m)\*

**36** Module with emergency luminaire

**37** Module with escape sign luminaire

\*appropriate for mounting in an IP54 system

For further accessories, see website.  
BIM objects are available.

# TRAQ Product range overview

	TRAQ	TRAQ Case	TRAQ Office
<b>Lengths (in module sizes)</b>			
m600	•		
m1200	•	•	•
m1500	•	•	•
<b>Material</b>			
PMMA LED lens optics	•		
Diffuser made of polycarbonate		•	
Diffuser made of PMMA and with RUN+ optic			•
<b>Beam spread characteristics</b>			
wide-beam, double asymmetric, asymmetric, concentrated beam	•		
all-round beam		•	•
<b>Light distribution indirect component</b>			
14%			•
<b>Luminous flux of luminaire (min – max.)</b>			
1580–16500 lm	•		
2650–6200 lm		•	
4250–5600 lm			•
<b>Colour temperature</b>			
3000 K, 4000 K	•	•	•
6500 K	•	•	
<b>Glare value</b>			
UGR ≤ 19, Lmax < 3000 cd/m²	•		•
UGR ≤ 22	•	•	
UGR ≤ 25		•	
<b>Light control</b>			
ON/OFF	•	•	•
ON/OFF-MultiLumen (adjustable)	•	•	
DALI2	•	•	•
<b>Operating temperature range</b>			
in IP20 system -10 to 40° C* **	•		•
in IP20 system -10 to 45° C*		•	
in IP54 system 0 to 35° C	•	•	
<b>Maintained luminous flux</b>			
L80 72'000h (guaranteed over the entire temperature range)	•	•	•

## Accessories for additional glare control for TRAQ:

Louvre Upcycling Set **TRAQ** for lens modules.

Emergency light (3h Dali2) with single battery for 11-pole power supply profile possible.

All models available for ceiling, wall and pendant mounting, chain and wire suspension (except **TRAQ Office** not for wall mounting).

\* Emergency variant: min. 0°C

\*\* High-lumen variant: max. 35°C

read the full story:



For more information, please visit [www.regent.ch/en/traq](http://www.regent.ch/en/traq)  
#peoplelightourway



Subject to technical modifications.  
We assume no liability for printing errors.